

New Moranbah Hospital



Main entry

Concept design - subject to change



Queensland
Government

New Moranbah Hospital



Inpatient room two bay

Concept design - subject to change



Queensland
Government

New Moranbah Hospital



Emergency non acute

Concept design - subject to change



Queensland
Government

New Moranbah Hospital



Staff room

Concept design - subject to change



Queensland
Government

New Moranbah Hospital



Waiting room

Concept design - subject to change



Queensland
Government

New Moranbah Hospital



Ambulance bay

Concept design - subject to change



Queensland
Government

New Moranbah Hospital



Hospital entrance

Concept design - subject to change



Queensland
Government

Site plan

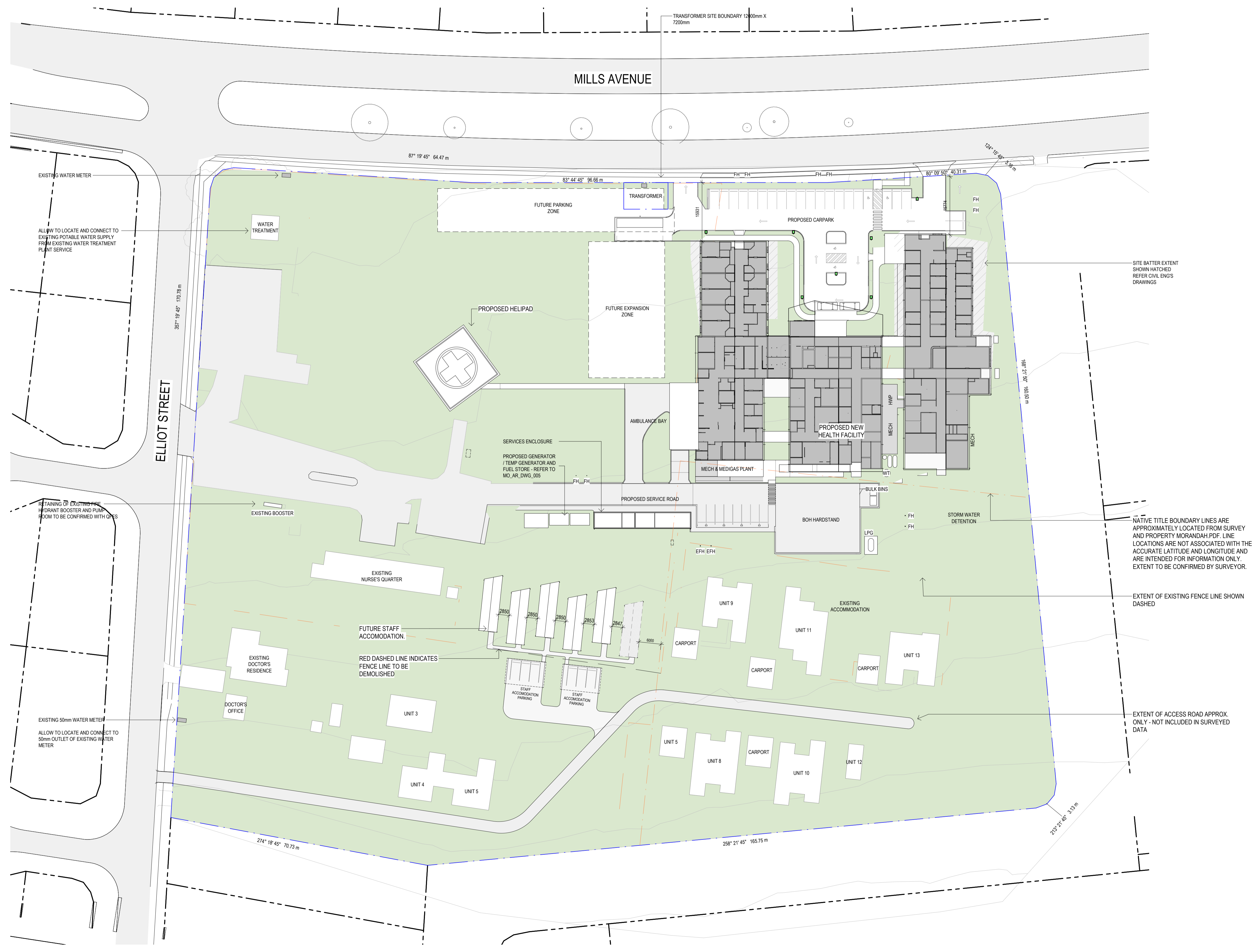

Hospital layout



- AMBULATORY CARE
- AMBULATORY CARE CIRCULATION
- EMERGENCY DEPARTMENT
- EMERGENCY DEPARTMENT CIRCULATION
- GYMS / ALLIED HEALTH
- INPATIENT UNIT
- INPATIENT UNIT CIRCULATION
- MEDICAL IMAGING
- MEDICAL IMAGING CIRCULATION
- STAFF
- STAFF CIRCULATION
- SUPPORT
- SUPPORT CIRCULATION

MILLS AVENUE

Your feedback in the design

In 2021 we asked the community three questions about the physical features of the new hospital and received 357 responses. Here's what you told us and how we have used your feedback when designing the hospital.

What services are most important to you and the community?

- > Emergency care
- > Care for admitted patients
- > Maternal and Child Health Services
- > Mental Health Services and AODS
- > Nutrition and dietetics services

What we are building

- A new hospital with more emergency department treatment spaces and better equipped to respond to emergency situations
- An emergency department with a modern resuscitation bay with new equipment
- An expanded medical imaging department which includes a CT scanner for the first time
- The first helipad at Moranbah Hospital to allow for more efficient transfers to other hospitals. This will also free up the ambulance as they will no longer need to transfer helicopter retrievals to the airport
- An improved ambulance bay to provide better access for ambulances transferring patients to hospital and to other facilities
- A modern hospital with 12 inpatient beds and more ensuite bathrooms
- Enhanced medical imaging services, an ambulatory care area, gymnasium and an enhanced outpatient department
- Space for staff training with a simulation room to provide a dedicated space for our clinicians to enhance their skills
- Rehabilitation gym for patients recovering from injury and illness
- More consultation spaces for clinicians
- Comfortable waiting rooms for people waiting for appointments
- A large conference space that can be used by the community
- A hospital with allied health, child health, antenatal and postnatal care, and mental health care under the one roof.

Which amenities are the most important to you and the community?

- > Aboriginal artwork representative of the local custodians
- > Culturally safe care
- > Upgraded equipment
- > More natural light, plants and gardens

What we are doing

- Planning artwork for the new hospital in consultation with First Nations people
- Displaying the Mackay HHS Health Equity artwork that symbolises our commitment to building culturally safe health systems that are First Nations lead and that focus on improving health and wellbeing for Aboriginal and Torres Strait Islander peoples.
- Including a large conference space that can be used as a meeting room by the community
- Building a hospital with new equipment including a CT scanner
- Planning new landscaping and building internal courtyards for more outdoor space
- Relocating the prize-winning rose garden and incorporating it into the landscape design. The transplanting work will be done by a local horticulture expert.

Do you have any suggestions about how we can create a better hospital environment that is welcoming and culturally safe?

- > Space for family
- > Comfortable waiting area
- > Carparking
- > Outdoor accessible garden space
- > Clear wayfinding

What we are doing

- Ensuring the family room, funded through community donations, will be replicated to provide a comforting space for patients and loved ones outside the ward
- Building a large central waiting room and playroom, as well as a separate waiting room for allied health services
- Increasing the number of car parks to 22 car parks as well as a turn-around drop off area and a covered entry for all-weather access
- Relocating the prize-winning rose garden and incorporating it into the landscape design. The transplanting work will be done by a local horticulture expert.
- Committing to seeking feedback on wayfinding through our Moranbah and Dysart Hospital Consumer Reference Group.

